

Changing a CF Card – TS910 / TS915

Before you start swapping the CF cards in any tills, first ensure that the power cable is disconnected. If there's any power going through the till when the card is taken out or inserted it can corrupt the card and render it unusable.

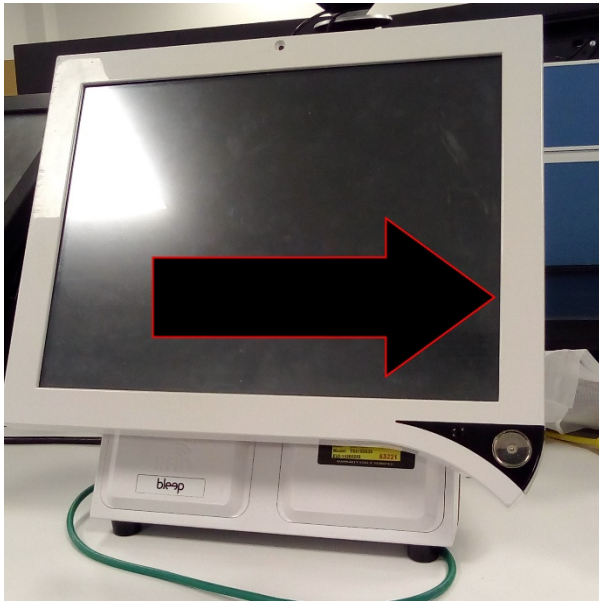

The CF card is located on the right-hand side, as you are looking at the till from the front. You can see the cover for the CF card slot on the side. This pulls out, although they can sometimes be a little stiff.



Then you can see the slot. Pay attention to the pins at the back. It's important that the FC card slots into these properly. If it's forced in without being properly aligned, then the till will not work and require repair.

Changing a CF Card – TS910 / TS915

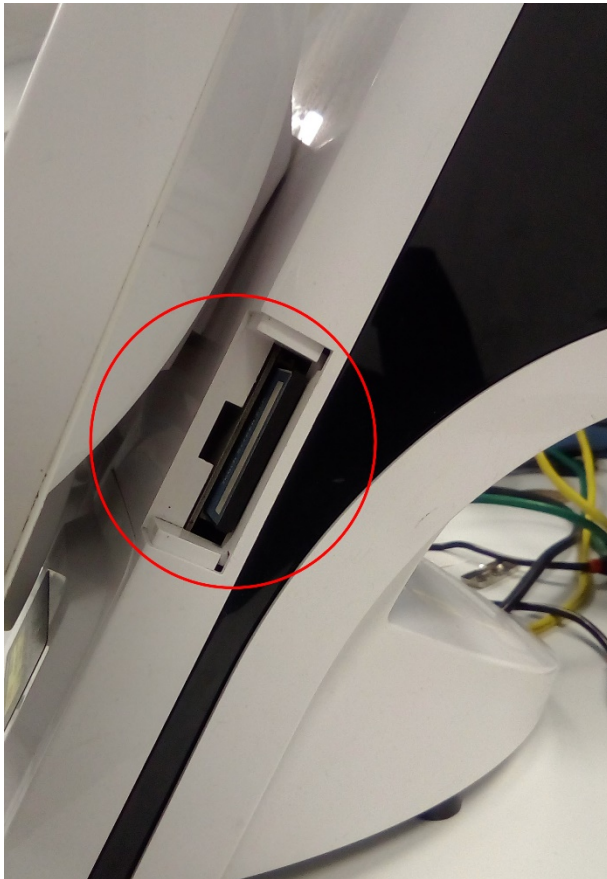

Carefully remove the CF card from the faulty unit and bring it to the loaner. Line it up in the guide rails on either side of the slot. The sticker of the card should be facing up. Once you've got that lined up push the card into place. Don't force it, just push gently until it's in as far as it goes.



Once that's in then you can reconnect the power and turn the till back on. If you get an error along the lines of "insert boot media" then the till isn't seeing the card. Often, it is just not properly seated. Double check the card is in correctly, and if you're still having issues then call the support line for advice.